

RIGID PLANK

Manufactured by
Proline
floors

STAIR NOSING INSTRUCTIONS

1. Peel back sheet underlay before gluing planks to stair case.

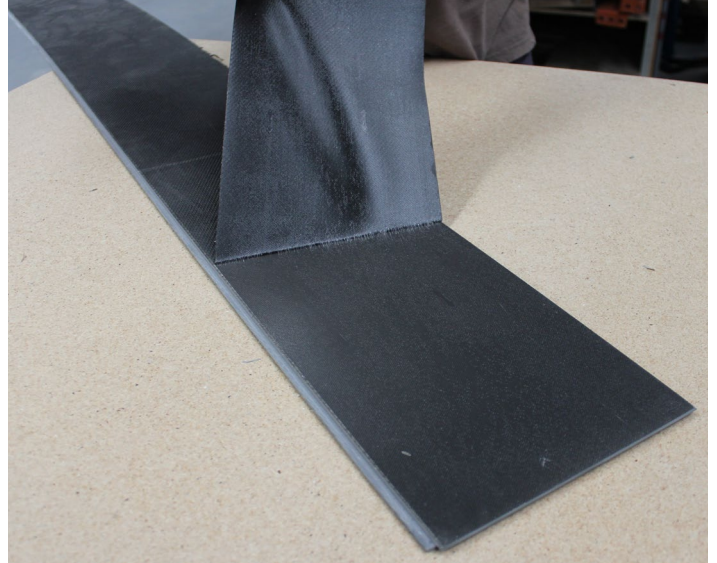

2. Glue the areas indicated for maximum bond with the stair frame.

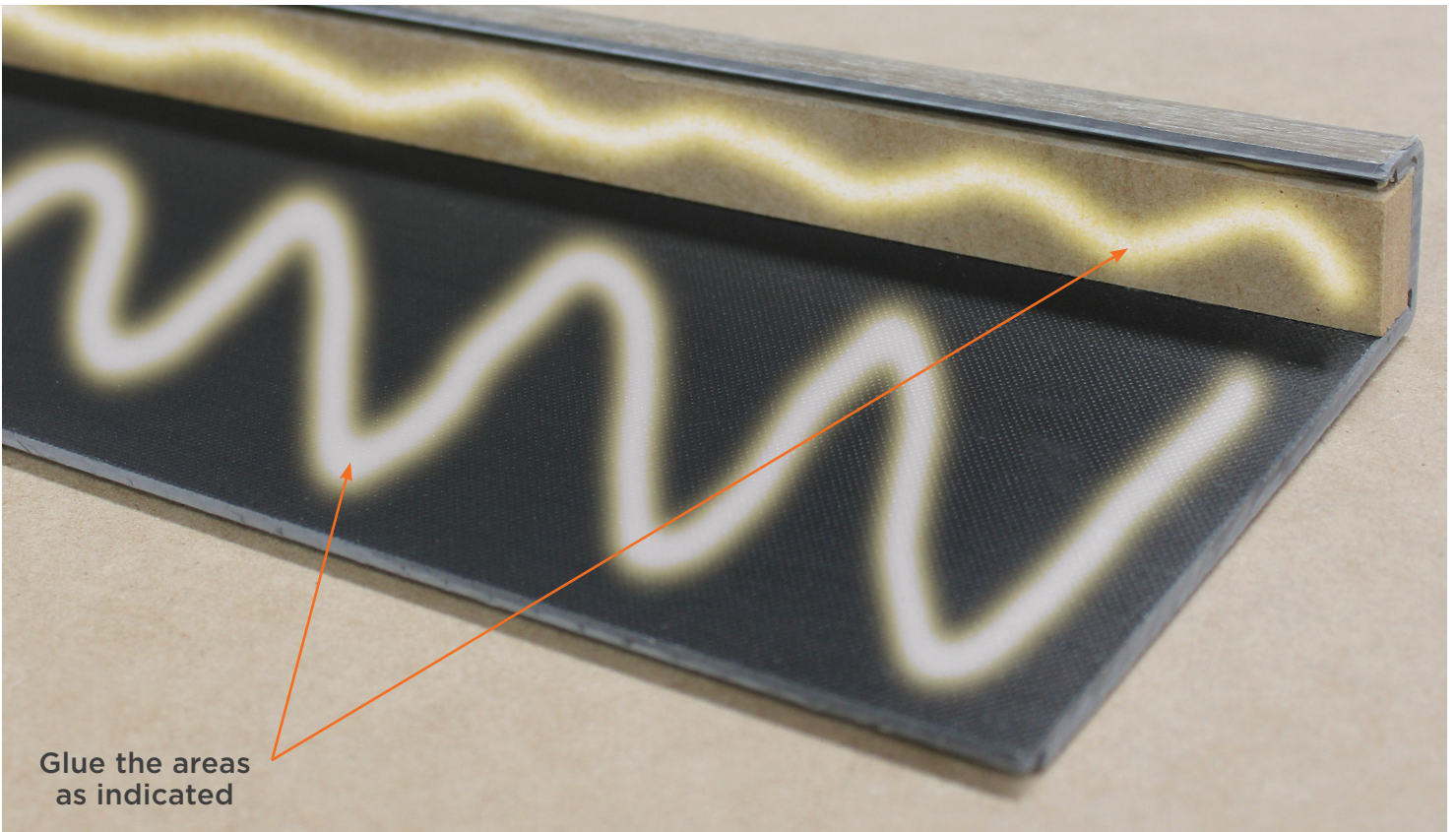

FOR MORE INFORMATION CALL (02) 9525 5241

STAIR NOSING INSTRUCTIONS

Diagram of installation process.

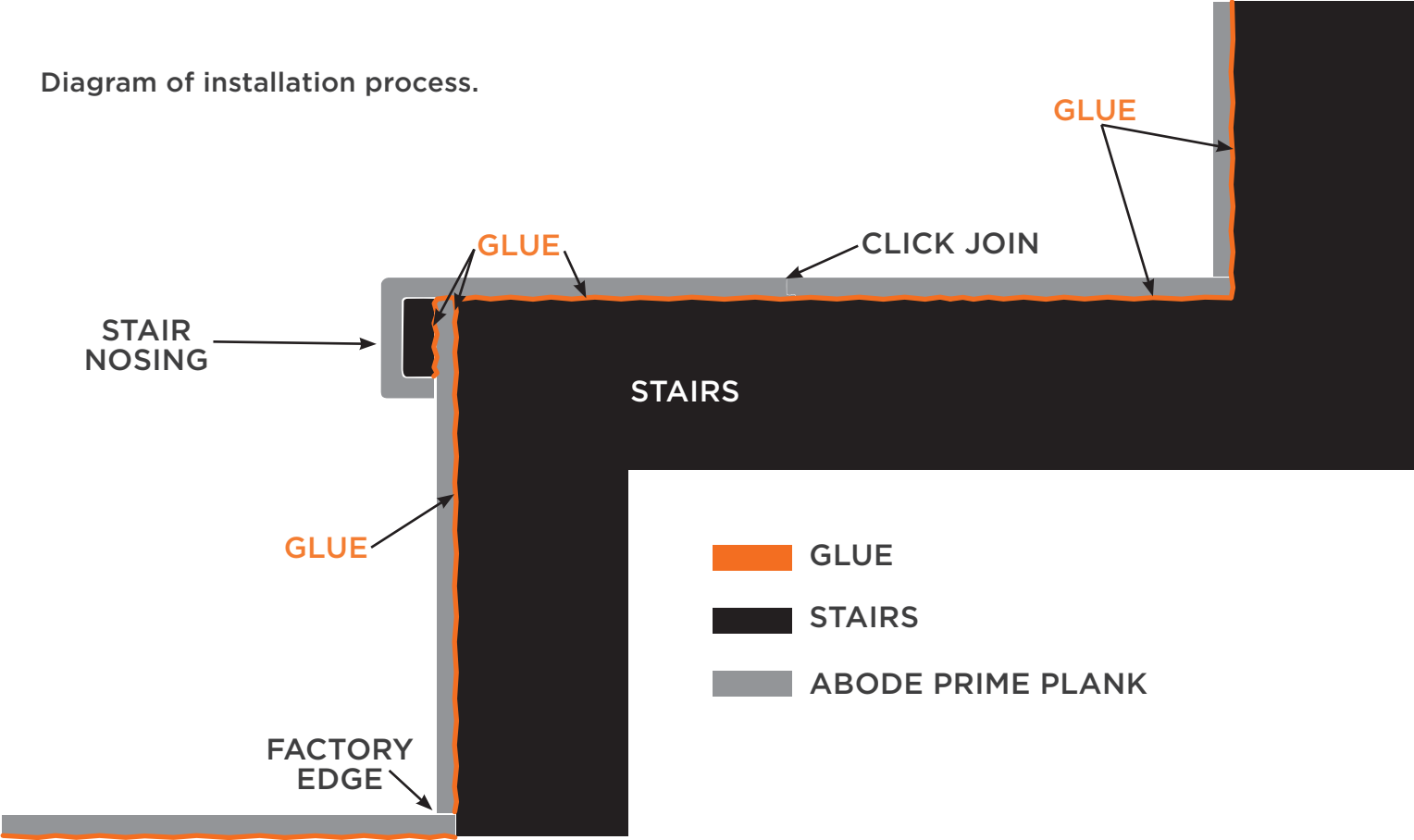

Finished product

